

# Hercules-RT series Superior Group



★ General ★★ Better ★★★ Unique

## Performance ▶▶▶

- ★★★★ Wide Input Range 80-300 VAC
- ★★★ 1.0 Output Power Factor
- ★ Input THDI <3%
- ★ Output THDv <1% linear load
- ★ Recharge to 90% battery capacity within 4 hours

## System ▶▶▶

- ★ True online double conversion Topology
- ★ DSP Control
- ★ IGBT conversion component
- ★ Tens of kHz, high frequency PWM
- ★ Easy Battery Replacement

## Operation mode ▶▶▶

- ★ Normal Mode : Control V./ freq. sync. to line
- ★ ECO Mode : via bypass within Programable range
- ★ Freq. Mode : Control both V. & F.
- ★ Start-able without battery (AC Start)
- ★ High Efficiency ECO Mode
- ★★★★ OVCD or Outlet Programmable Management\*

## User Interface ▶▶▶

- ★★★ Mimic LCD Display
- ★ Free Power Management Software
- ★ Optional SNMP & Relay Cards

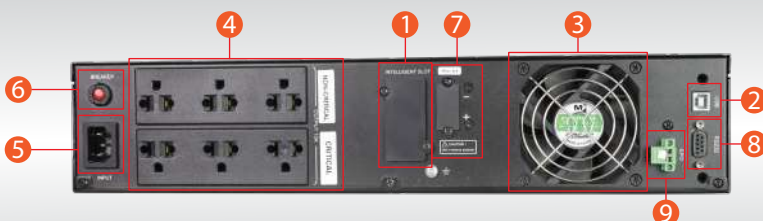

- |                     |                 |        |
|---------------------|-----------------|--------|
| 1. Intelligent Slot | 5. Input Power  | 9. EPO |
| 2. USB              | 6. Breaker      |        |
| 3. Cooling Fan      | 7. Battery Port |        |
| 4. Outlet           | 8. RS232        |        |

\*Option all Model

# SPECIFICATION

| MODEL                   |                         | HE-RT-3K  |  |  |
|-------------------------|-------------------------|---|--|--|
| CAPACITY                |                         | VA/WATT   |  |  |
|                         |                         | 3KVA/3KW(PF1.0)   |  |  |
| INPUT                   | Voltage Range           | 80 ~ 300V (80 V @ 0-30% Load)   |  |  |
|                         | Frequency Range         | 50 / 60 Hz ± 0.5%   |  |  |
|                         | Phase                   | Single phase with ground  |  |  |
|                         | Power Factor            | ≥ 0.99  |  |  |
|                         | Generator Input         | 1.5 x UPS Rating Power  |  |  |
| OUTPUT                  | Voltage Range           | 208 / 220 / 230 / 240 Vac ±1% (selectable)                                |  |  |
|                         | Phase                   | Single phase with ground  |  |  |
|                         | Frequency Range         | 50 / 60 Hz ± 0.5%   |  |  |
|                         | Current Crest Ratio     | 3:1   |  |  |
|                         | Harmonic Distortion     | <3% Linear load; <5% Non-linear load                                      |  |  |
|                         | Protection              | Short Circuit Protection  |  |  |
|                         | Output Waveform         | Pure Sine Wave  |  |  |
|                         | Outlet                  | 6 Thai Universal  |  |  |
|                         | Overload Capacity       | Line Mode   | 2 min @ 100%~110% ; 1 min @ >100%~130% ; 3 s @ > 130%                |  |
|                         |                         | Battery Mode  |  |  |
| EFFICIENCY              | AC Mode                 | 91%   |  |  |
|                         | Battery Mode            | >88%  |  |  |
|                         | ECO Mode                | 97%   |  |  |
| BATTERY                 | Number of Batteries     | 6   |  |  |
|                         | Battery Capacity        | 12V / (7/9)Ah   |  |  |
|                         | Backup Time @load 2100W | >5 Mins   |  |  |
|                         | Recharge Time           | 4 Hours (to 90%)  |  |  |
|                         | Charging Current        | 1.5 A (Max.)  |  |  |
|                         | Battery Type            | Sealed Lead Acid Maintenance Free   |  |  |
| TRANSFER TIME           |                         | AC to DC  | Zero   |  |
| INDICATOR               | LCD                     | In/Out  | Voltage / Frequency / Utility Present / Utility Lost                 |  |
|                         |                         | Load  | Amp / Watt / VA / Overload / Load level / % Load                     |  |
|                         |                         | Battery   | Voltage / Battery Level / % Battery / Remaining Time / Charging Mode |  |
|                         |                         | Mode  | Operating Mode Icon / Warning / Operating-Fault-Warning Message      |  |
|                         |                         | Mimic   | Yes  |  |
| ALARM                   | Battery Mode            | Sounding every 4 seconds  |  |  |
|                         | Low Battery             | Sounding every second   |  |  |
|                         | Overload                | Sounding twice every second   |  |  |
|                         | Fault                   | Continuously Sounding   |  |  |
| DIMENSION               |                         | W x H x D (mm)  | 438 x 88 x 610   |  |
| WEIGHT                  |                         | kg  | 27.34  |  |
| ENVIRONMENT             | Operating Environment   | 0-40° C   |  |  |
|                         | Relative Humidity       | 0-95% (NON-CONDENSING)  |  |  |
| COMMUNICATION           | Noise Level             | <50dB @ 1 Meter   |  |  |
|                         | USB                     | Yes   |  |  |
|                         | Dry Contact             | EPO, Dry in, Dry out  |  |  |
|                         | Smart Slot (Option)     | SNMP Adapter / Relay Card / RS485   |  |  |
| INTERNATIONAL STANDARDS | Product standard        | TIS 1291 Part 1-2553, TIS 1291 Part 2-2553 Class C2, TIS 1291 Part 3-2555 |  |  |
|                         | QMS                     | Certified Quality Management System ISO9001                               |  |  |
|                         | EMS                     | Certified Environmental Management System ISO14001                        |  |  |

Specifications are subject to change without prior notice



มอก 1291 เล่ม 1-2553  
มอก 1291 เล่ม 2-2553  
มอก 1291 เล่ม 3-2555



**Syndome Electronics Industry Co.,Ltd.**

66 ซอยประชาอุทิศ 59 แขวง 3 เขตบางนา ถนนสุขุมวิท กรุงเทพฯ 10140

Tel: (662)8726900 (auto) Fax: (662)8726909

URL: <http://www.syndome.com> Email: [public@syndome.com](mailto:public@syndome.com)